

Detail at Exterior Doors NTS

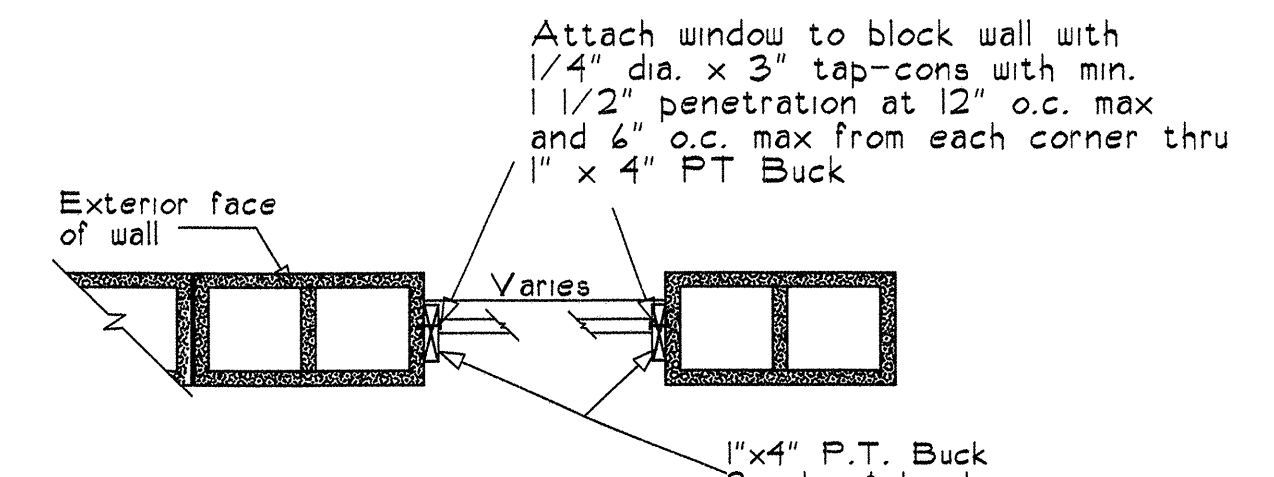

Detail at Windows NTS

Filled Cell Masonry Column With One #5 From Footing To Beam. Conc. Fill To Be 3000 PSI See Floor Plan For Location

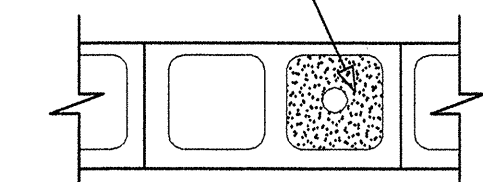

Single Filled Cell Column NTS

Filled Cell Masonry Column With One #5 From Footing To Beam Each. Conc. Fill To Be 3000 PSI See Floor Plan For Location

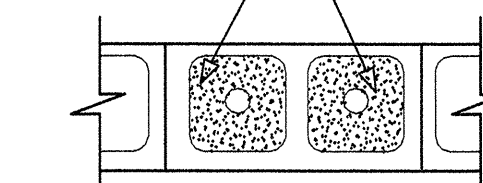

Double Filled Cell Column NTS

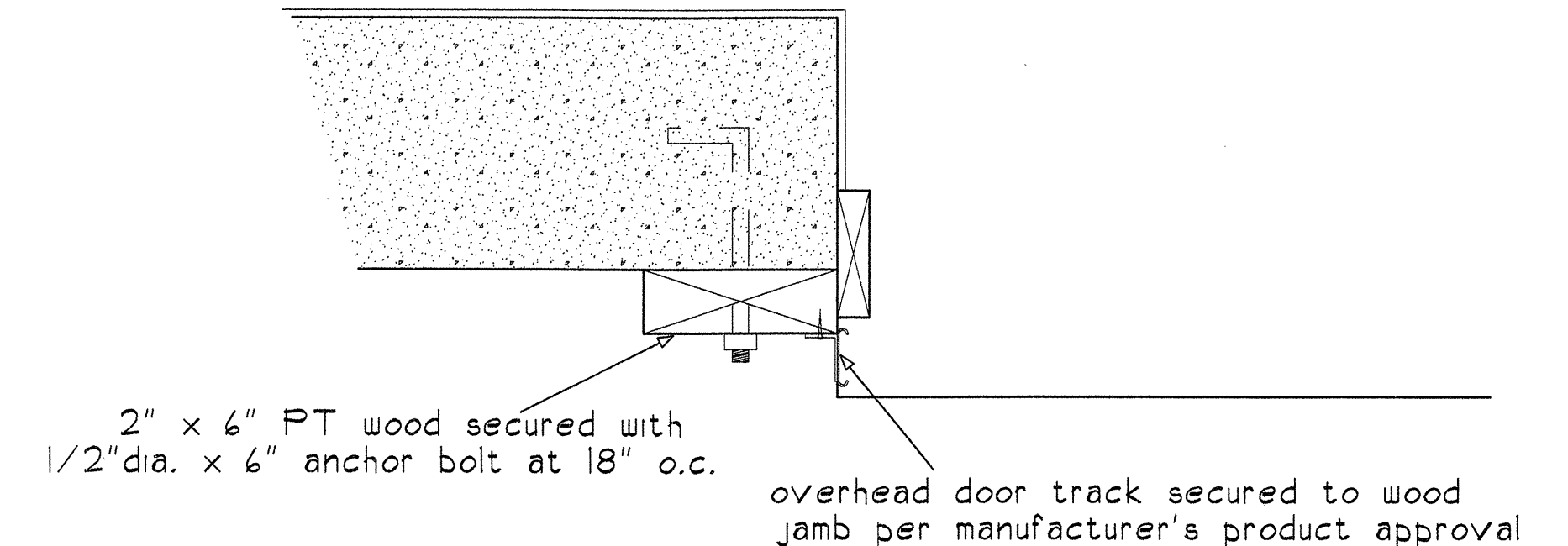

Garage Door Jamb Detail

NTS

ALL GARAGE DOORS AS SPECIFIED IN PRODUCT APPROVAL ON THESE PLANS. DOORS TO MEET WIND PRESSURE STATED IN PERMIT INFO BOX ON THESE PLANS

FOUNDATION PLAN

SCALE: 1/4" = 1'-0"

FOUNDATION NOTES:

- Any changes to plans must be submitted to the architect for approval before proceeding with construction.
- Contractor shall be responsible for verification of all notation and dimensions prior to start of construction.
- ALL Concrete used for slabs shall be 3,000 PSI concrete min., and ALL Concrete used for vertical filled cells, continuous tie beams etc., to shall be 3,000 P.S.I. concrete and/or 4,000 P.S.I. grout mix min.
- Soil conditions assumed to be 2500 psf and stable. This shall be confirmed by soil borings which shall be provided in writing to this firm by owner/contractor prior to start of any construction.
- Verify all recess thickness at shower floors, all floor finishes as selected by owner, door sills & thresholds etc.... prior to placing any slabs.
- Contractor to provide filled cell with concrete and 1 #5 bar vert. at 48" o.c. max. Provide (1) filled cell on each side of openings up to 5'-11" wide. Provide (2) filled cells on each side of openings from 6'-0" to 9'-11" and Provide (3) filled cells on each side of openings from 10'-0" and up. Contractor to see plans for any other condition used. Foundation walls shall have filled cells at 24" o.c. unless otherwise noted (see section)
- Contractor to provide for Form Board Survey - Form Board Survey to be provided to Truss Company prior to truss construction
- ALL Reinforcing steel shall be grade 60, meeting ASTM A-16 and A-35 specifications. ALL Anchors to be A-307 steel.
- Provide a minimum of 3" concrete protection at footings and 1-1/2" concrete protection at beams for ALL reinforcing bars.
- Contractor to provide the Architect with truss shop drawings including ALL truss cut sheets showing ALL truss reactions prior to START OF FOUNDATION WORK for strap and footing size verification.

----- = 2" x 6" bearing stud walls - see sections. Insulate with R-11 batta at bathrooms & between A/C and Non-A/C spaces

Termite Protection for New Construction as per F.B.C. 1816.1 CONTRACTOR TO REFERENCE F.B.C. BUILDING 1816.1 FOR FURTHER REQUIREMENTS

Soil treatment used for subterranean termite prevention inside the foundation perimeter shall be done after all excavation, backfilling and compaction is complete.

If soil area is disturbed after initial chemical soil treatment, area shall be re-treated with a chemical soil treatment including spaces boxed or framed.

Treatment must be in accordance with the rules and laws established by the Florida Department of Agriculture and consumer services.

Protective sleeves around piping penetrating concrete slab on grade floors shall not be of cellulose-containing materials and shall have a min. wall thickness of 0.010" and shall be sealed within the slab using a noncorrosive clamping device to eliminate the annular space between pipe and sleeve. NO TERMICIDES shall be applied inside the sleeve per FBC Plumbing 305.1.2

Revisions :
Date Drawn : 8-13-15
Drawn by: S.J.E.
Checked by: D.R.B.

Residence For: Mr. & Mrs. Iacovone
Martin County Florida

Braden & Braden AIA, PA
Architects - Planners
411 Coconut Avenue
Tel: (112) 281-8258
Fax: (112) 281-8253
E-mail: braden@aia.com
Stuart, FL 34916 #AACC00032

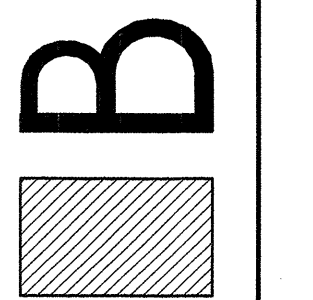

Sheet 4 OF 9
Comm # 15-155